

202-48

Garnetson Ridge with Chris Olney, CCCD 6/23/100

Location ASCENT	p'	Δp	Δe	e calc	e map	time	R
(A) Eropus Cr-t Last Clove Rd.	30.54	0			1240	8:20 AM	$\frac{2980 - 1240'}{30.54 - 28.66'}$ $= \frac{1740'}{1.88''}$ $= 0.926$
(B) 1 Chestnut bur	30.36	0.18	167	1407			
(C)	30.20	0.34	315	1555			
(D)	30.07	0.47	435	1675			
(E)	30.04	0.50	463	1703			
(F)	29.98	0.56	519	1759			
(G) live chestnut	29.88	0.66	611	1851			
(H) letters not used by error	29.70						
(I)	29.64						
(J)	29.82						
(K)	29.70	0.84	778	2018			
(L)	29.64	0.90	833	2073			
(M)	29.62	0.92	852	2092			
(N)	29.54	1.00	926	2166		9:20	
(O)	29.52	1.02	945	2185			
(P) Vista cut	29.45±	1.09	1009	2249			
(Q)	29.42	1.12	1037	2277			
(R)	29.34	1.20	1111	2351			
(S)	29.28	1.26	1167	2407		10:30	
(T)	29.04	1.50	1389	2629			
(U)	28.99	1.55	1435	2675			
(V) SNY blaze	28.90	1.64	1519	2759			
(W)	28.97	1.57	1454	2694			
(X) Pine Hill Trail (see desc 28.90 → 28.82)	28.90				2803		
(Y) Trail Junction	28.85	1.69	1565	2805	2830	10:59	
(Z) see descent on back							
(AA)							
(BB)							
(CC) Lean-to	28.66	1.88	1740	2980	2980	11:07 - 11:37	
(RR) trailhead Last Clove	28.66				1540		

Location DESCENT 202-49 p Δp Δe e calc e map time R

CC	Lean-to	28.70	1.58	1440	2980	2980	11:37	
BB	one ASH	28.74	1.54	1403	2943			2980-1540'
AA	one ASH	28.78	1.50	1367	2907			30.28'' - 28.70''
Z	OAK	28.82	1.46	1330	2870			
Y	Trail Junction	28.87	1.41	1285	2825	2830	11:44	= 1440'
DD	Kiln #4	28.93	1.35	1230	2770			<u>1.58''</u>
EE	SNR blaze	28.96	1.32	1203	2743			
FF	Kiln #2	29.01	1.27	1157	2697			= 0.911
GG	Kiln #3	29.03	1.25	1139	2679		12:50	
HH TT	Kiln #5	29.14 29.18	1.14 1.10	1039 1002	2579 2542			
II	Kiln #6	29.26	1.02	929	2469			
JJ	springs	29.32	0.96	875	2415			
KK	log roads: BB	29.38	0.90	820	2360			
LL	bigtooth	29.45	0.83	756	2296			
MM SS	BASS <small>Chestnut</small>	29.49 29.52	0.79 0.76	720 692	2268 2232			
NN	cross-road	29.64	0.64	583	2123			
OO	dead Chestnut	29.82	0.46	419	1959			
PP	log road	29.88	0.40	364	1904			
QQ	hemlock	29.95	0.33	301	1841			
RR	Lost Cove Trail Head	30.28	0.00			1540	1:45	

(B) Chestnut bur found on granite but not the tree. BB, HEM, OST, OAK, RM

(C) OAK cut ca. 1985 to 1990, ± 100y old, 33" multiple stem. Established late 1800s

(D) Asplenium platyneuron looks like a miniature PA

more oak cut

(E) 20" Bigtooth

(F) Oak sprouts from stumps 4" x 25' suggesting year of logging.

VIB ACER

(F) Oak stumps with bark off and BB thicker suggesting logging between 1900-1985. Dead Chestnut + sprout

(G) Chestnut collected from young sprout (lvs. & twigs). HAMAM, BB sprouts growing out of the log road.

OAK 110y, bark rotten on stump, established ca-1870s.

(L) Chestnut sprout 2073

(M) Chestnut, BB, ASH 2092

(O) SUG, B, BC, RM, MO, ASH 2185

(P) BB, OST 2249

Vista cut 3yr RM sprout suggests 1998. OAK stump 100y, cut 1998, 18", established 1898±.

Open grassy area along road

ANTI-BI-MC

OAK stump, cut 1998, 23", 120y, estab. 1878.

below (D) Stumps from 1950s & 1970s; ASH

(Q) to (R) Many stumps, NO OAK here. Flagging with "improved" on it

(S) MO maturing after the last cuttings

(V) 3 Yellow SW blaze paint 2959 on double OAK & B

(BB) ²⁹⁴³ One ASH, highest
(AA) ²⁹⁴⁷ One ASH, 2nd highest

(Z) OAK, highest, across trail from a large dunned crown. e-p. # 119

14" SUG stump, 70y old bark on. Cut 1990±, established 1920±.

(EE) Forest Preserve signon 2943 an ASH

(FF) About midway from trail to Kiln #2, find dead SUG leaning to SE with Armillaria. Look for Conopholis.

YB+B on trail

(GG) OAK on trail 2679
(HH) Conopholis in Kiln #5

(II) OST, R CYNOS 2469

(JJ) IMP spring 2415

(LL) BIGTOOTH 2296

(SS) Chestnut, live, but top partly dead. Burs on ground, 4 collected. 60'± x 14". Trunk sprout opposite red till bank.

(MM) BAST 2232

(OO) HAMAM, dead 6" CHEST-NUT 1959

(PP) HEMLOCK, few, not worth banking. 1841

more 2579

(TT) 2579 Conopholis
Platanthera orbiculata with leaves only

Charcoal Kiln Details

6/23/00
with Chris
Olney

202-51

Kilns observed along log road which follows the ridge crest from E to W.

Humus seems NOT to accumulate ^{on top of charcoal} in the Kilns. Instead, charcoal is either on the surface or mixed in the shallow humus, 1 to 2" thick under the litter. Beneath the humus is not charcoal but reddish A horizon.

MK found #4 on
6/23/00
Chris Olney
spotted #526

The Lost Clove Trail
must have originated
as a CHARCOAL road,
not a log road:
Charcoal must have
been hauled out to
BIG INDIAN, not
Pine Hill.

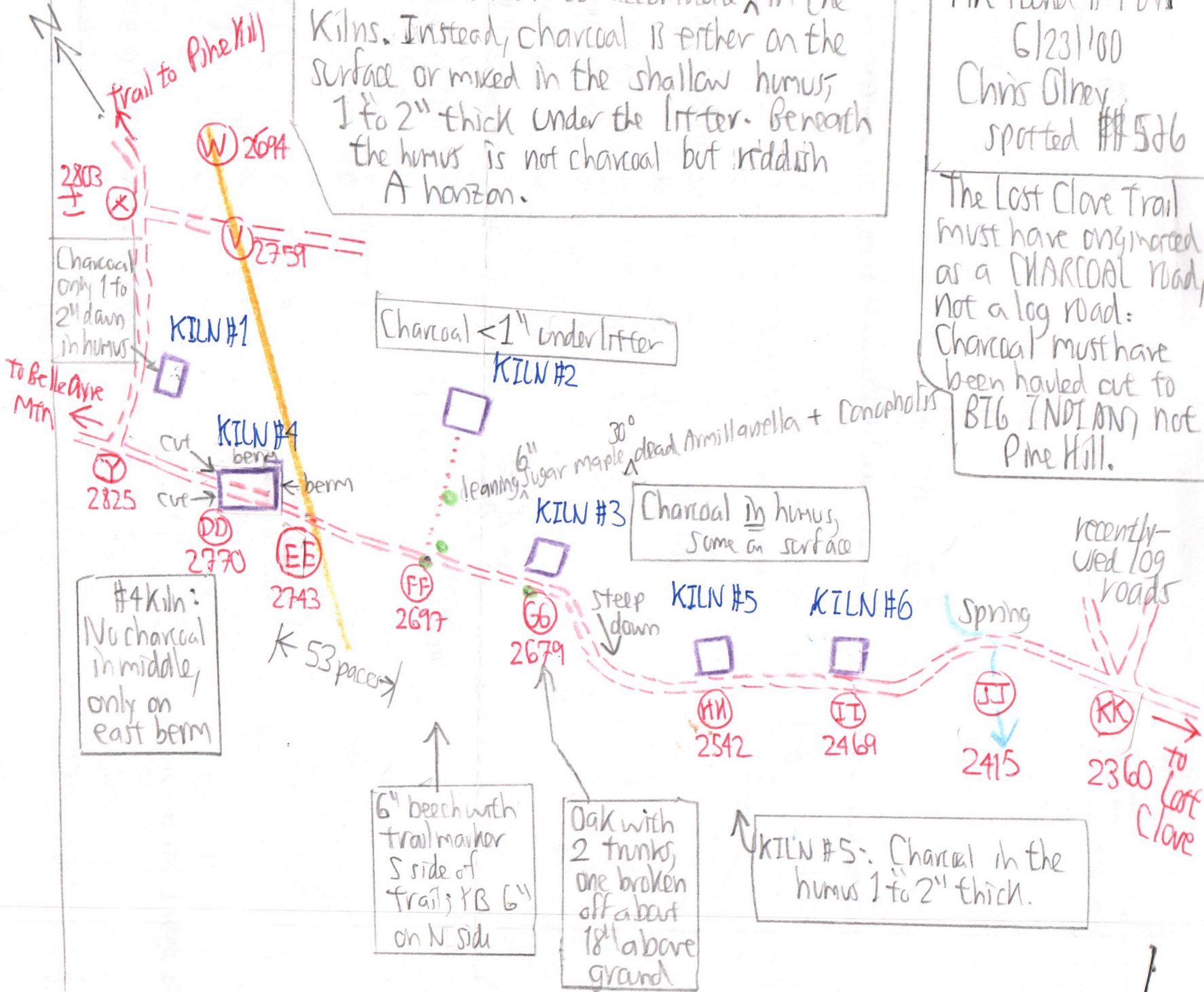

See P
202-4

NO

trail to Pine Hill

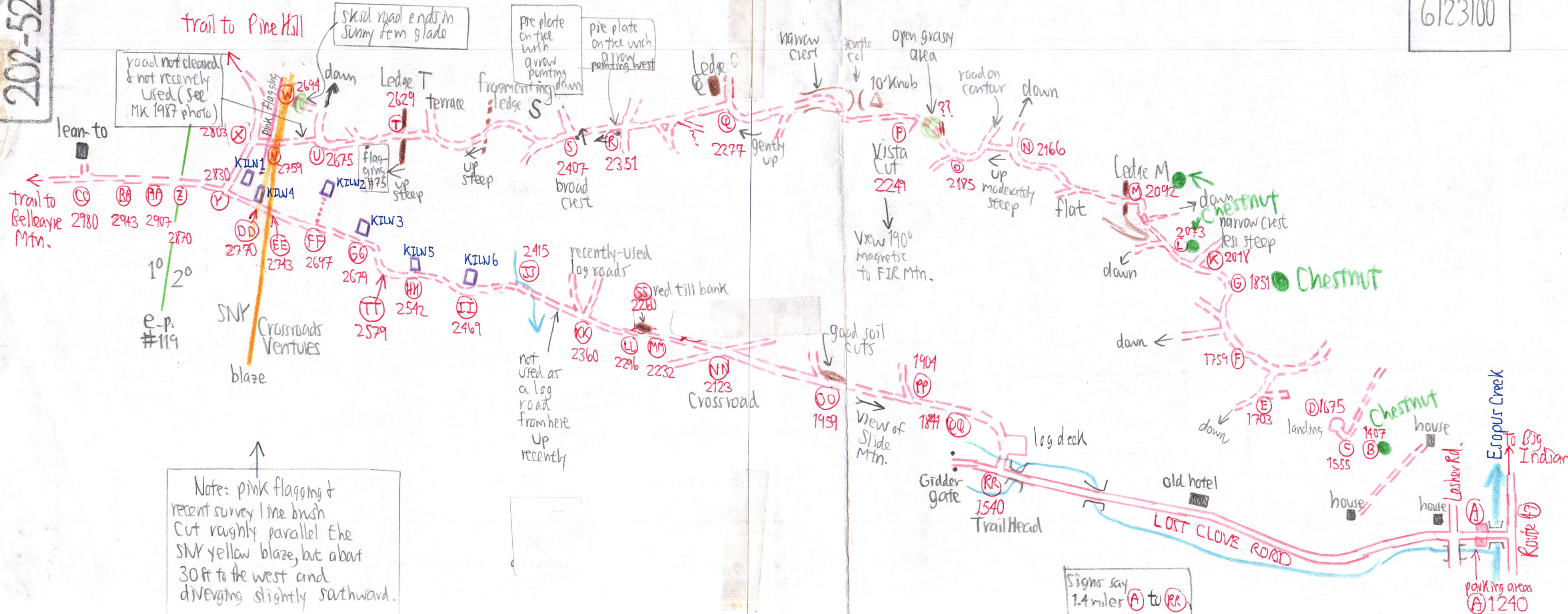

Note: pink flagging & recent survey line brush cut roughly parallel the SNY yellow blaze, but about 30 ft to the west and diverging slightly southward.

Signs say 1.4 miles (A) to (RR)

road not cleaned & not recently used (see MK 1987 photo)

skid road ends in sunny fern glade

pre plate on tree with arrow pointing down
pre plate on tree with arrow pointing west

narrow crest

open grassy area

road on center down

down Chestnut narrow crest less steep

Chestnut

Chestnut house

Esopus Creek to Big Indian

parking areas (A) 1240

trail to Belleayre Mtn.

e.p. #119

SNY Crossroads Ventures blaze

flagging 2775

recently-used log roads

red till bank

good soil cuts

View of Slide Mtn.

log deck

old hotel

LOST CLOVE ROAD

Lasher Rd.

Route 41

lean-to

Ledge T terrace

Ledge C

Ledge M

View 190° magnetic to FIR Mtn.

down

down

down

Route 41

parking areas (A) 1240